

Technical Data Sheet

optibelt ALPHA LINEAR/V F2 groove free - ST

PU Flat Belt, Optionally with Fabric PAR,
Open-Ended / Endless Joined



Dimensions, Tolerances

Profile:	F2
Total thickness:	2.0 mm
Width tolerance:	±0.5 mm
Thickness tolerance:	±0.2 mm

Construction

Polyurethane:	Thermoplastic, 92 Shore A, white
Tension cord:	Steel, Ø 0.9 mm
Fabric, optional:	Polyamide, one-sided (PAR), green

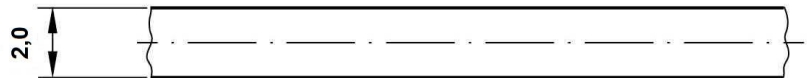

Cord-Zugkräfte, Mindestlänge, Riemengewicht

Riemenbreite ¹ b [mm]	15	25	30	40	50	75	100
F _{Br} [N], ALPHA LINEAR	6640	12320	16120	21840	28480	43680	60800
F _{Zul} [N] ² , ALPHA LINEAR, ε _{Zul} =0,55%	1660	3080	4030	5460	7120	10920	15200
F _{Zul} [N] ² , ALPHA V	830	1540	2015	2730	3560	5460	7600
Minimum length ALPHA V [mm]	-	700	-	-	900	900	900
Weight per meter [kg/m]	0.061	0.101	0.122	0.162	0.203	0.304	0.405

¹ Kleinere und Zwischenbreiten möglich ² Zulässige Zugkraft F_{Zul} = 25% / 12.5% (ALPHA LINEAR / V) der Bruchkraft F_{Br} der Corde $c_{spez} = F_{Zul} / \epsilon_{Zul}$

Inside and outside idlers

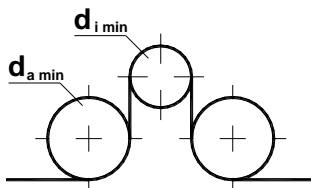

Minimum diameter of a plane inside idler: $d_{i \min} = 60 \text{ mm}$

Minimum diameter of a plane outside idler: $d_{a \min} = 90 \text{ mm}$