

# Technical Data Sheet

## optibelt ALPHA LINEAR / V F2 groove free - ST

PU Flat Belt, Optionally with Fabric PAR,  
Open-Ended / Endless Joined



### Dimensions, Tolerances

Profile:	F2
Total thickness:	2.0 mm
Width tolerance:	±0.5 mm
Thickness tolerance:	±0.2 mm

### Construction

Polyurethane:	Thermoplastic, 92 Shore A, black
Tension cord:	Steel, Ø 0.9 mm
Fabric, optional:	Polyamide, one-sided (PAR), black

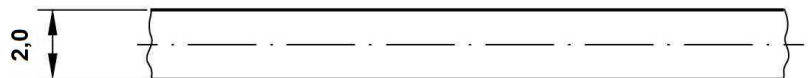

### Cord-Zugkräfte, Mindestlänge, Riemengewicht

Riemenbreite <sup>1</sup> b [mm]	15	25	30	40	50	75	100
F <sub>Br</sub> [N], ALPHA LINEAR	6640	12320	16120	21840	28480	43680	60800
F <sub>Zul</sub> [N] <sup>2</sup> , ALPHA LINEAR, ε <sub>Zul</sub> =0,55%	1660	3080	4030	5460	7120	10920	15200
F <sub>Zul</sub> [N] <sup>2</sup> , ALPHA V	830	1540	2015	2730	3560	5460	7600
Minimum length ALPHA V [mm]	-	700	-	-	900	900	900
Weight per meter [kg/m]	0.061	0.101	0.122	0.162	0.203	0.304	0.405

<sup>1</sup> Kleinere und Zwischenbreiten möglich <sup>2</sup> Zulässige Zugkraft F<sub>Zul</sub> = 25% / 12.5% (ALPHA LINEAR / V) der Bruchkraft F<sub>Br</sub> der Corde C<sub>spez</sub> = F<sub>Zul</sub> / ε<sub>Zul</sub>

### Inside and outside idlers

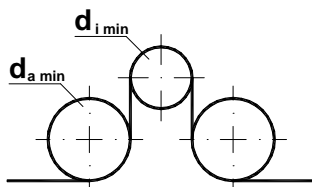

Minimum diameter of a plane inside idler:  $d_{i \min} = 60 \text{ mm}$

Minimum diameter of a plane outside idler:  $d_{a \min} = 90 \text{ mm}$